

- Built-in
- Circular
- Aluminium
- Aluminium natural finish



Circular molded aluminium louvres type BLR-F

Circular louvres made of moulded aluminium with natural finish

Application

- Louvres for air supply and exhaust in ventilation systems

Material

- Moulded aluminium
- Inox mesh

Colour

- Aluminium natural finish

Composition

- Moulded aluminium body with enclined aluminium blades. Equipped with welded insect screen. Can be removed in mechanical ventilation.
- Size Ø315 and Ø400 different look

Mounting

- Fitted by nails or by casting

Text for tender

- The circular external air louvres shall be of the circular type, made of moulded aluminium and equipped with insectscreen
- ATC Type **BLR-F**

Order example

- **BLR-F, 160**

Explanation

BLR-F = Type grill

160 = Connection diameter

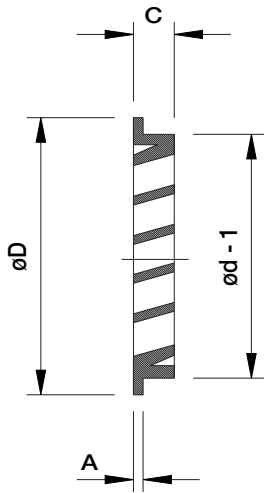
Dimensions

BLR-F	ød -1 [mm]	A [mm]	øD [mm]	C [mm]	Aeff (m ²)	Aeff %	Aeff(m ²) incl.screen	Aeff % incl.screen
100	99	3	132	25	0.0037	47	0.0026	33
125	124	3	152	25	0.0054	44	0.0038	31
150	149	3	181	25	0.0096	54	0.0067	38
160	159	3	189	25	0.0100	50	0.0070	35
200	199	3	231	25	0.0167	53	0.0116	37
250	249	3	278	25	0.0233	47	0.0162	33
315	314	7.5	340	25	0.0412	53	0.0288	37
400	399	7.5	440	25	0.0675	54	0.0477	38

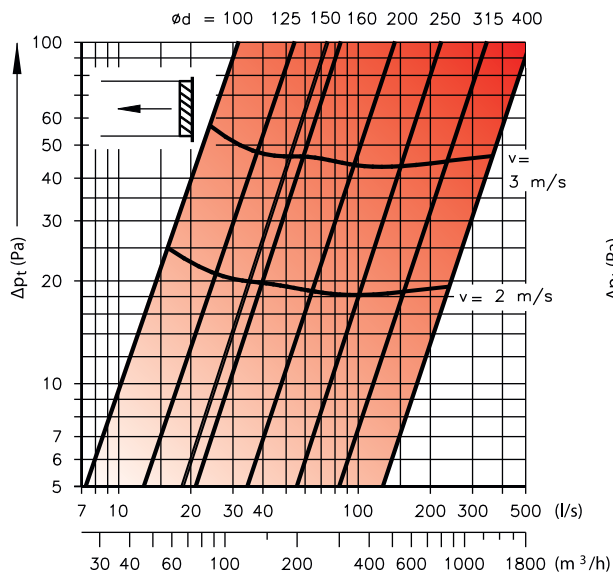
Selection graph

Graphsymbols

- Q = Air volume in l/s and m³/h
- Pt = Total pressure drop in Pa
- v = Average velocity in duct in m/s
- Ød = Connection diameter of the louvre in mm